

SINK BASE CABINET (PA)

| CODE | ITEM | QTY |
|------|-------------------------|-----|
| A | Right Left Side Panel | 2 |
| D | Bottom Panel | 1 |
| H | Back Panel | 1 |
| J | Toe Kick Panel | 1 |
| M | Front Face | 1 |

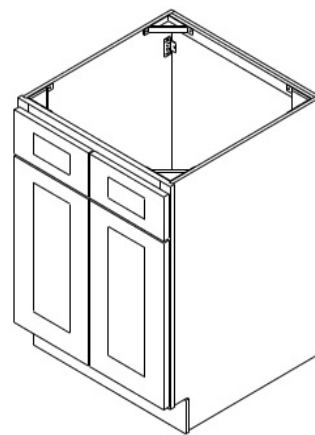

EASY ASSEMBLY METAL CLIP SYSTEM



- Align Clips ① and ②
- Slide ① into ②
- Insert locking screw into clip pair
- Tighten all screws

STEP 1

- Lay H flat; grooves facing upward
- Insert A into metal clips of H (refer to Metal Clip System)

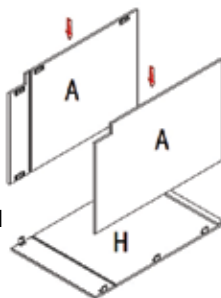

STEP 2

- Slide D into grooves of A

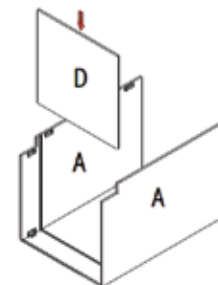

STEP 3

- Attach M onto D and A (refer to Metal Clip System)
- Attach J onto bottom of A using the Metal Clip System

